

GW-SS316 Multi Grip Stainless Steel 316 Rivet

Dome head · Stainless steel 316 body · Stainless steel 316 stem · Multi-grip
3.2 mm (1/8") - 4.8 mm (3/16")

Features

- Multi-grip capability accommodates wide variations in material thickness
- Corrosion resistant, suitable for applications in marine and hostile environments
- Good hole fill provides strong, vibration resistant joints
- Compensates for irregular, oversized, slotted or misaligned holes
- Can stop sheet movement in non-standard holes
- Retained stem avoids damage, electrical problems or rattling caused by loose stems

Material

- Body: Stainless steel 316
- Stem: Stainless steel 316

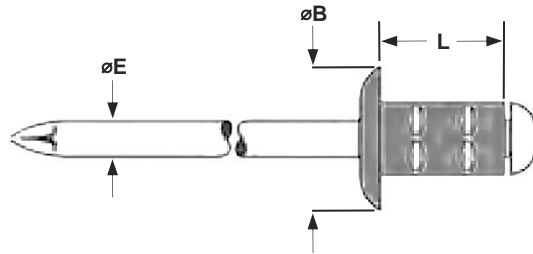

Part No.	Size Ø	Grip Range		Hole Size	L	ØB	ØE	Shear (typical) kN	Tension (typical) kN
		nom.	min.						
GW-SS316-0411	3.2 (1/8")	3.0	8.0	3.3	11.0	6.5	2.2	1.45	2.30
GW-SS316-0510	4.0 (5/32")	1.0	6.5	4.1	10.0	8.0	2.7	2.65	3.60
GW-SS316-0610	4.8 (3/16")	1.0	6.5	4.9	10.0	9.5	3.2	4.00	5.00
GW-SS316-0615		5.0	10.0		15.0				



Can't find what you are looking for?

We can provide customized finishing and colouring.
Contact your nearest [Gripwell](#) team for assistance!